

# EAGLE CREST

ESTATES™



**Presented by:**

***Teri Seidl***

**John L. Scott®** | **REAL ESTATE**  
**TRI-CITIES PASCO**

**John L. Scott®**

**REAL ESTATE**

This office is independently owned and operated.



EQUAL HOUSING  
OPPORTUNITY

**TERI SEIDL**

**Realtor/Broker**

**(509)430-2755**

**Tseidl@johnlscott.com**



# Table of Contents

---

## **Executive Summary**

The Offering . . . . .	1
------------------------	---

## **Location Overview**

Demographics . . . . .	2
------------------------	---

### **Plat Map**

Phase 2 . . . . .	3
-------------------	---

Images/Views . . . . .	4
------------------------	---

<b>Approved Builders</b> . . . . .	6
------------------------------------	---

<b>Contact</b> . . . . .	7
--------------------------	---

**\*\*Please Request GeoTech Report, CCRS, EXHIBIT A, SELLER DISCLOSURE..PLAT \*\***

## Disclaimer

The information provided in the following document is proprietary and confidential. It is intended to be reviewed only by the party receiving it from John L Scott Tri Cities Pasco (JLS) and should not be made available to any other person or party without the consent of JLS. This memorandum is delivered under the terms and conditions of a Confidentiality Agreement, which has been executed by the recipient as Reviewer.

This document has been arranged to provide summary, unverified information to prospective buyers, and to establish only a preliminary level of interest in the subject property. JLS makes no guarantees or representations; regarding the information including, but not limited to, warranties of content, accuracy and reliability. All interested parties should go through the necessary measures to gather information, pertinent to the subject property, to verified the accuracy of information. The information has been prepared by sources we deemed to be reliable, however, JLS has not verified and will not certify the information contained herein. Prospective buyers should take appropriate steps to verify all of the information set in this document. JLS exclude unequivocally all terms, conditions, and warranties arising out of this documents and excludes all liability for loss and damages arising there from.



# Executive Summary

---

## *Property Overview*

Now Building Phase 1

Custom Built Homes

Type: Vacant Land/Residential

Lot Sizes: .5 to 1 Acre Lots

Location: Located off Road 100,

Close to freeway access, Schools

& Shopping

## The Offering

John L. Scott Tri-Cities Pasco is proud to be offering the following land property: **Eagle Crest Estates**

Very few few places exist to build along the Columbia River with a view, yet close to town and Interstate 82.

- Situated on a ridge line offering panoramic views of the Columbia River and the rolling hills of the valley.
- includes 26, half acre(+/-), lots with 8 of those lots on the ridge line.
- Our qualified featured builders include, Greg Senger Construction, Titan Homes, Dream Builders, Hammerstrom, and J&J Kelly.
- Utilities include electricity, Internet, and city water, natural gas and septic required



# Location Overview

---

Population: 275,740

Median Income: \$72,733

2014 Tri-Cities Tourism:

- \$398.2 Million

Transportation:

- Convenient for drivers  
traveling from Seattle,  
Tacoma, Vancouver,  
Portland, Spokane, Coeur  
d' Alene, and Boise.
- Commercial Airport
- Accessible by bus, train,  
and private aircraft

Other

- More than 50 wineries
- 300 days of sunshine
- 8 Golf Courses

Demographics: *Tri-Cities, WA*

The Tri-Cities, WA consists of Richland, West Richland, Kennewick, Pasco, and Benton City. Pasco was the first of the Tri-Cities to be incorporated, in 1891. Kennewick was incorporated in 1904, and Richland followed in 1910.

Population in the Tri-Cities is 275,740 and the median household income is \$72,733. The region's economy is anchored in R&D, technology, manufacturing, agricultural, retail, and healthcare. Some major employers are: Batelle/PNNL, Lockheed Martin, Bechtel Nation, CH2M Hill, ConAgra/LambWeston, Amazon, Tyson Fresh Meats.

In 2014, the Tri-Cities brought in about \$398.2 million in revenue from tourism. The Tri-Cities is located in the Columbia Valley Wine Country with Red Mountain AVA & Horse Heaven Hills AVA. There are more than 50 wineries within a 30 minute car ride.

When it comes to traveling, the Tri-Cities is convenient for drivers who are traveling from Seattle, Tacoma, Vancouver, Portland, Spokane, Coeur d' Alene and Boise.

Throughout the year, there are about 300 days of sunshine and 8 golf courses here in the Tri-Cities.



# Location Overview

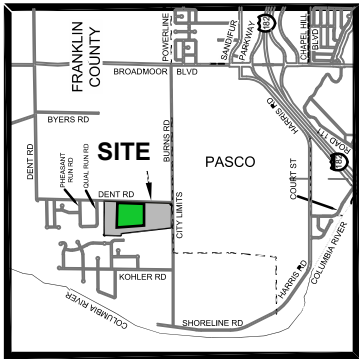

PHASE

2

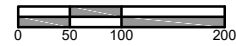

December, 2019

DENT ROAD

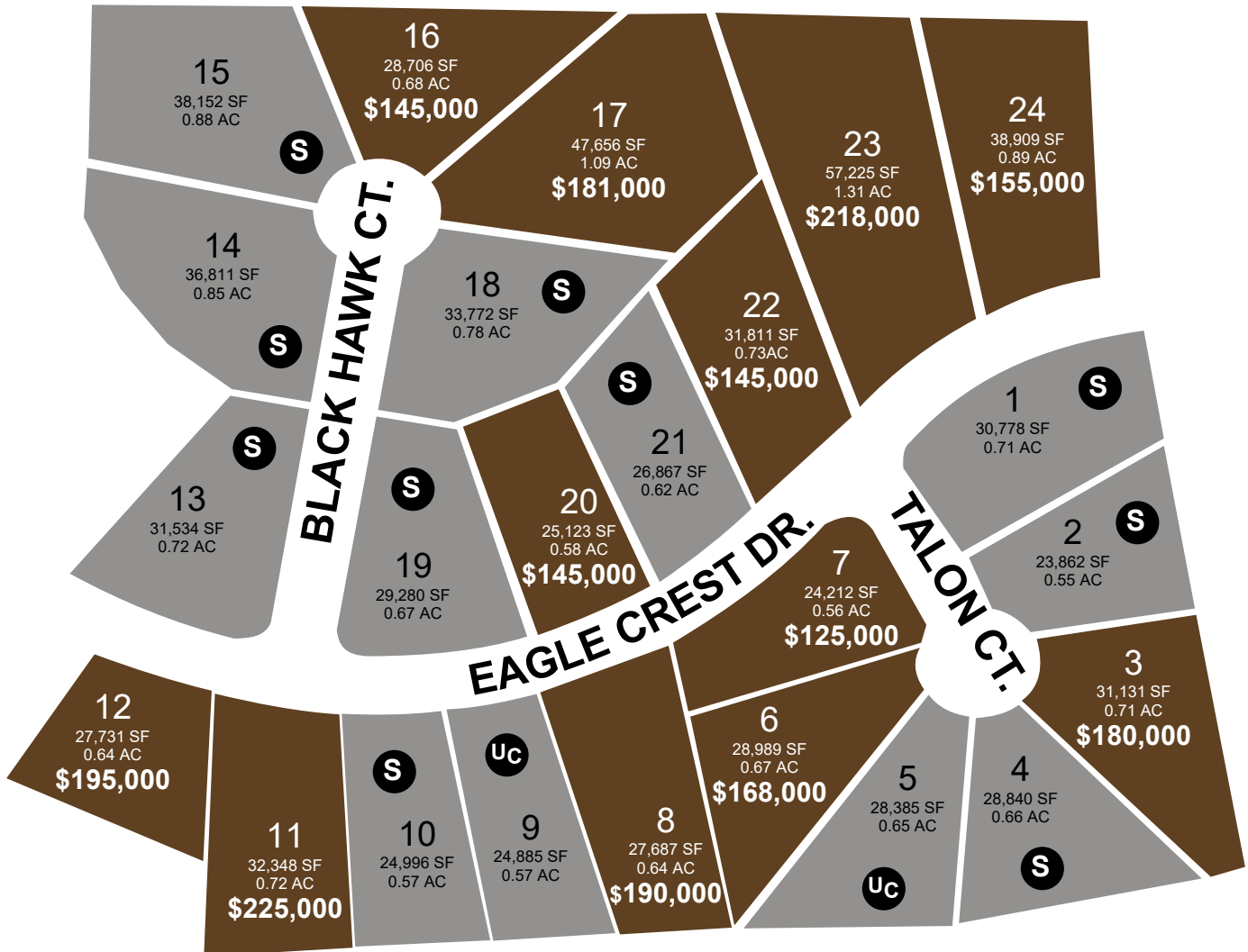

● SOLD/UNDER CONTRACT LOTS

● AVAILABLE LOTS





# Location Overview

---

This could be your view! Now Building at Eagle Crest Estates

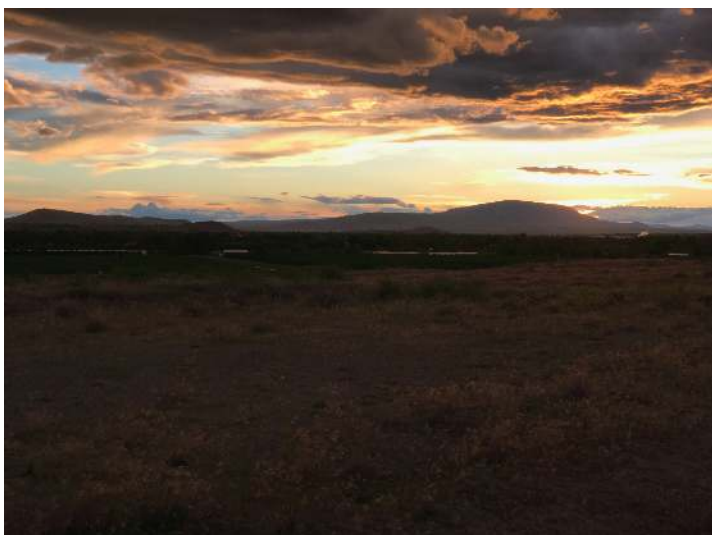



# Location Overview

---



# Approved Builders

---

1. Greg Senger Construction Inc.
2. J & J Kelly
3. Hammerstrom
4. Dream Builders
5. Titan Homes, LLC





# LET'S GET IN TOUCH

## Listing Agent Info

Teri Seidl

Cell: (509) 430-2755

Email: [tseidl@johnlscott.com](mailto:tseidl@johnlscott.com)

## Office Info

John L. Scott Real Estate Tri-Cities Pasco

Address: 5109 N. Rd 68, Ste. E, Pasco, WA, 99301

Office: (509) 547-5542

Website: [www.tricitiespascooffice.johnlscott.com](http://www.tricitiespascooffice.johnlscott.com)

Eagle Crest Estates Website

[www.eaglecrestestates.com](http://www.eaglecrestestates.com)

John L. Scott®